

Fast Response Photodetector



Features

High Response within 1.0 ~ 1.65 μm

Low Dark Current

Firm Coaxial Package and/or TO-46 Package

High reliability

1GHz Bandwidth

Planar Structure

Applications

Optical Transceiver

CATV

LAN

Optical Detection and Optical Measurement

Specifications

Parameter	Min.	Typ.	Max.	Unit
Wavelength Range	1.0	-	1.65	μm
Sensitive Diameter	-	75	-	μm
Dark Current (-5V)	-	0.5	2	nA
Capacitance (-5V)	-	0.6	0.8	pF
Linear Range	-70	-	3	dBm
1310nm Responsibility (-5V)	0.8	-	-	A/W
1550nm Responsibility (-5V)	0.8	-	-	A/W
Reflective Loss	-	-45	-40	dB
Bandwidth	-	1.0	-	GHz

Absolute Maximum Ratings

Forward Current	10mA
Optical Current	10mA
Reverse Voltage	25V
Power Waste	100mW
Operating Temperature	- 40 ~ + 85
Storage Temperature	- 40 ~ + 85

Ordering Information

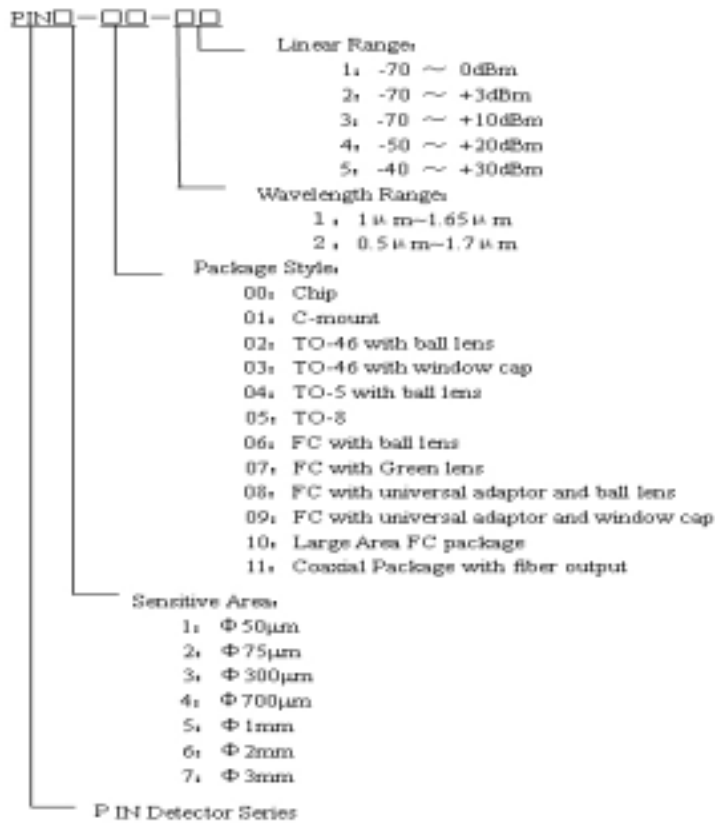

Mechanical Dimensions

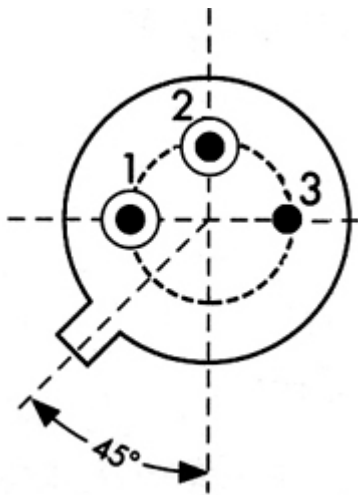

Bottom View (PIN21112/PIN20212)

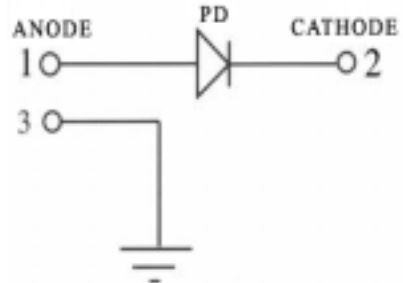

Inside Structure (PIN21112/PIN20212)

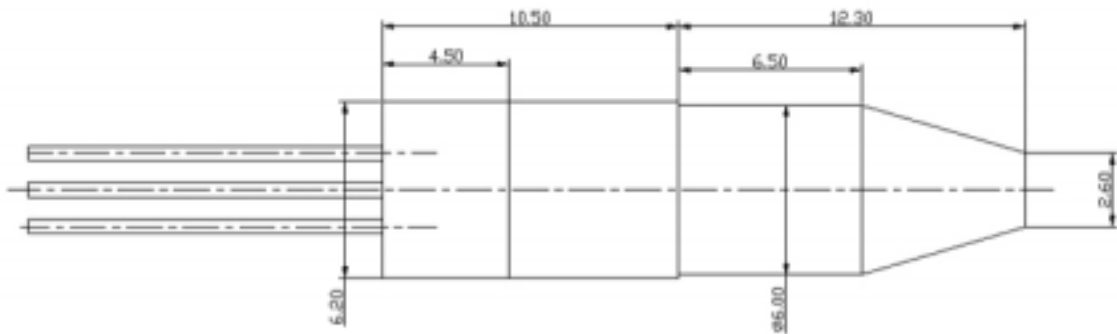

Outline Dimensions (PIN21112)

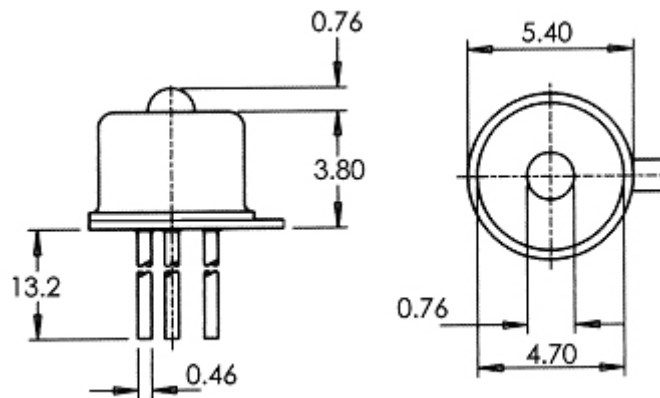

Outline Dimensions (PIN22212)

Typical Performance

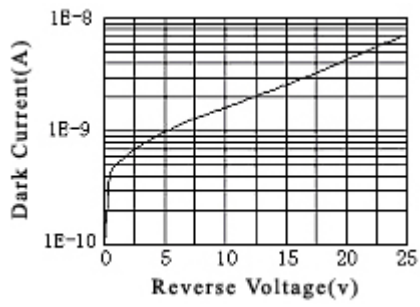

$I_d - V_r$ Characteristic Curve

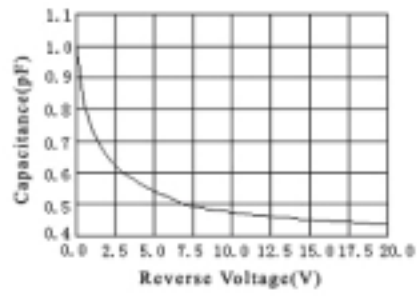

C-V Curve

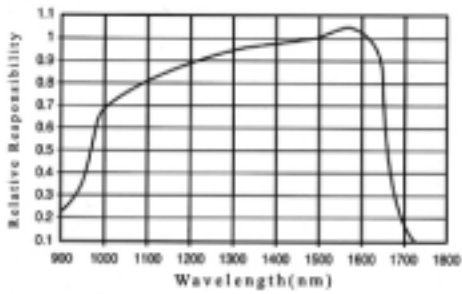

Typical Spectral Response

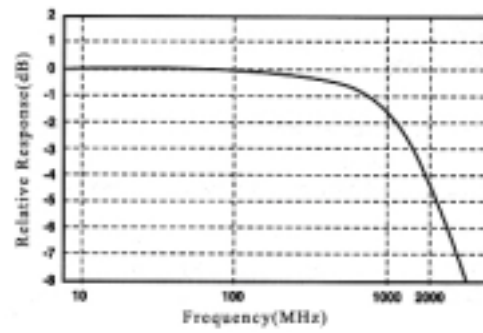

Response Curve